

RAFES URBAN ASTRONOMY CENTER EMERGENCY GUIDELINES

Call or text 911 in life threatening emergencies

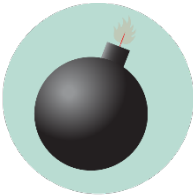

FIRE



BOMB THREAT



**GAS
LEAK**



HAZMAT



**SEVERE
WEATHER**



HAZMAT

Evacuation

PROMPTS: Fire alarm, direction from the UNT Police or City of Denton Fire Department, an Eagle Alert, a visibly life-threatening situation

- Gather those around you and quickly leave through the nearest exit.
- Ask those around you with limited mobility if they need help and provide assistance, as able.
- If you take notice of someone unable to evacuate, note their location and tell first responders as soon as possible.
- Those with access and functional needs should immediately go to the nearest fire refuge area and call 911.
- Move at least 200 feet away from the building and stay off fire lanes.
- Comply with directions from first responders.

Shelter

PROMPTS: Eagle Alert, Outdoor Warning Sirens

- Go indoors immediately.
- Seek shelter on the lowest level of the building, away from windows and exterior walls.
- For tornadoes: Encourage guests to shield their head and neck with arms and putting material such as furniture and blankets around themselves.
- If the event is HAZMAT related, completely turn off or seal off all external air sources including windows, doors, and air vents.
- Stay in shelter until an Eagle Alert is sent telling you it's safe to leave.

Medical Emergency

- Call 911 (or have someone call 911 for you).
- Send others to get an AED and to meet first responders at the door.
- Ask the individual if you have their permission to assist them.
 - If **YES**, provide first aid to the extent that you feel able.
 - If **NO**, move away from the individual and wait for first responders.
 - If **unconscious**, you have implied consent to provide assistance, as long as you are not negligent.
- Assist paramedics as needed when they arrive.
- Gather info and report the incident to Risk Management Services.



**MEDICAL
EMERGENCY**



**ACTIVE
THREAT**

Run. Hide. Fight.

PROMPTS: Eagle Alert; successive, loud shot noises; groups of individuals running and screaming

- **RUN** and escape the active threat if possible.
- **HIDE** from the active threat if escape is not possible.
- **FIGHT** the attacker as a last resort and commit to your actions.

CAMPUS EMERGENCY CONTACTS

<p>Any life-threatening emergency Active threat Acts or threats of violence Bomb threat Fire Hostage situation Life-threatening hazardous materials release Medical emergencies Natural gas leak Suicidal person Violent civil disturbance or demonstration Violent/threatening/hostile individual</p>	<p><i>Call or text 911 in life-threatening emergencies</i> 911</p>
<p>Any non-emergency concerns Civil disturbance or demonstration Disruptive person Elevator failure Suspicious person</p>	<p><i>UNT Police</i> 940-565-3000</p>
<p>Maintenance-related issues Power outage Water leak or flooding Property damage</p>	<p><i>UNT Facilities</i> 940-565-2700</p>
<p>Minor hazardous materials release</p>	<p><i>UNT Risk Management</i> 940-565-2109</p>

If you are unsure if a situation is or is not an emergency, always call 911.

RAFES URBAN ASTRONOMY CENTER EMERGENCY LOCATIONS AND SUPPLIES



Shelter Areas

- Restrooms in the Classroom Buildings

Evacuation
Assembly
Area

Evacuation Assembly Area

- The grassy area west of the main classroom buildings, *unless directed to go elsewhere by first responders or an Eagle Alert.*

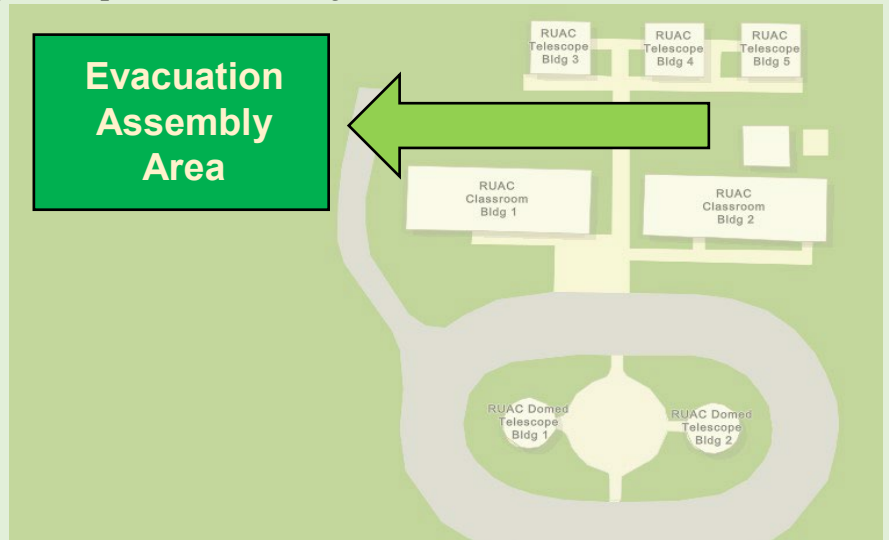

Medical Emergency Related Equipment

- **First Aid Kits:** on the supply shelf on the office side of Classroom 1
- **AEDs:** next to the left entrance in Classroom 1
- **Fire Extinguishers:** found in Buildings 1 and 2



Weather Closure Procedures for Rafes Urban Astronomy Center:

If there is an indication of severe weather, Emergency Management will provide information on the storm/rain chances via the **Severe Weather Potential Update** email. Emergency Management will provide information on:

- The timing of storms
- Expected severity of storms
- Impacts to road/driving conditions

NOTE: The roads leading out to the Observatory are prone to flash flooding. Based on information provided by Emergency Management, Rafes Observatory staff will determine whether or not to move/cancel labs. Before any group goes to the Rafes Observatory, the students meet at ENV 290. If weather is appropriate (no severe weather and not cloudy), students will be taken to Rafes Observatory. If the weather is expected to be severe or there are overcast conditions, the lab will be completed in ENV 290.

RUAC CLASSROOM #1

FIRST FLOOR PLAN

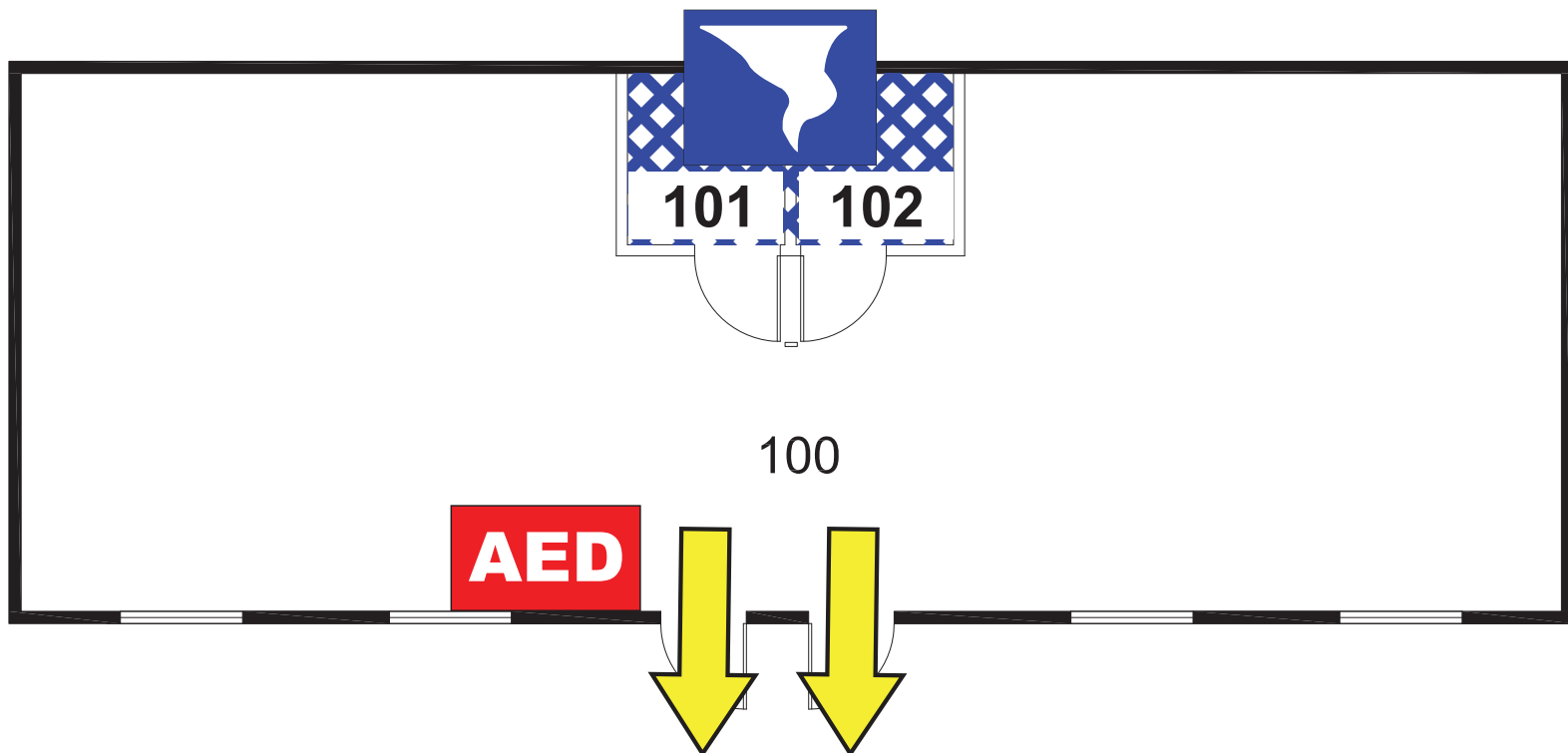

LEGEND

 Automated External Defibrillator

 Exit

 Shelter Area



RUAC CLASSROOM #2

FIRST FLOOR PLAN

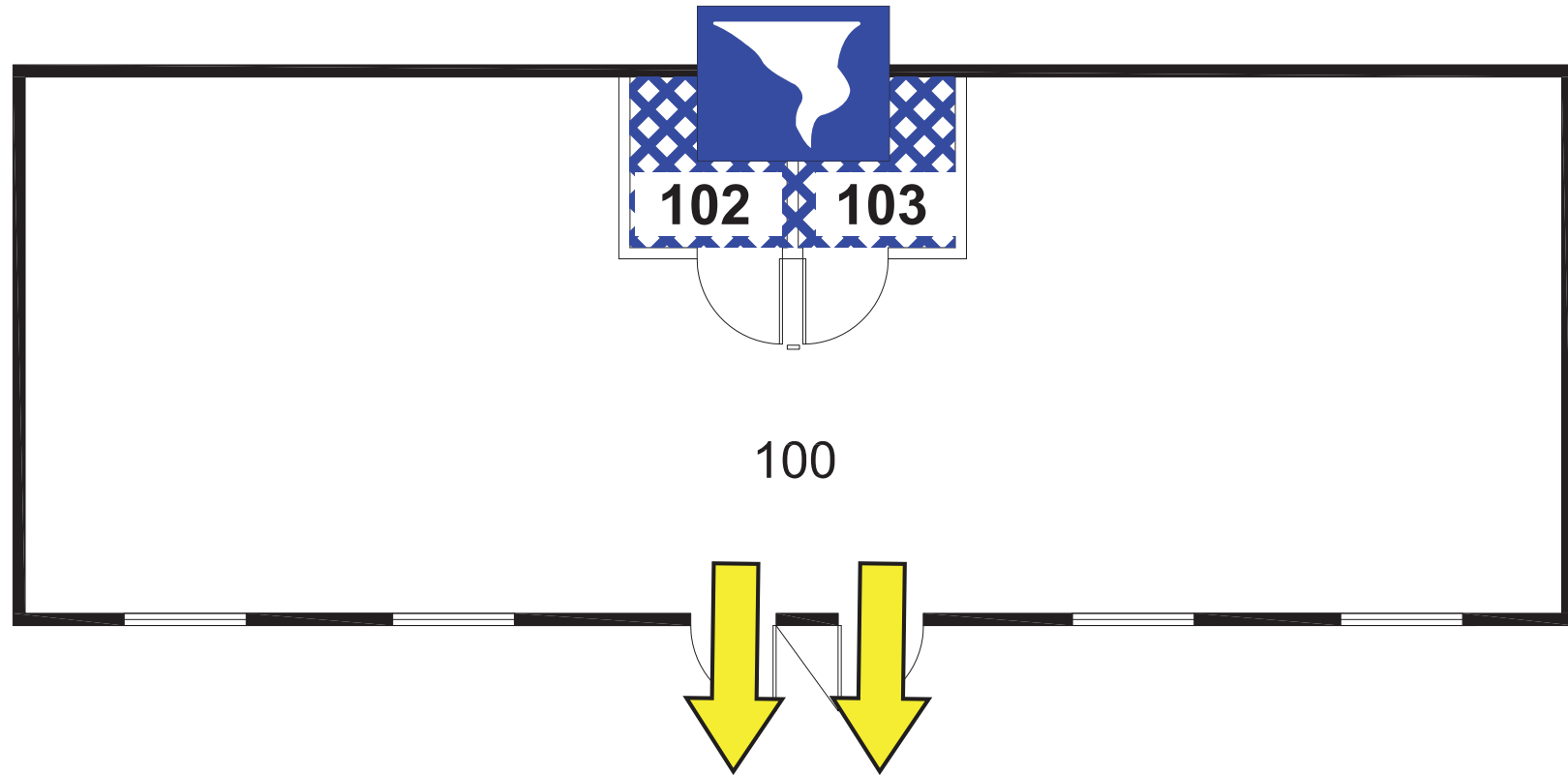

LEGEND



Exit



Shelter Area

