

DISCOVERY PARK

BUILDING EMERGENCY GUIDELINES

Call or text 911 in life threatening emergencies



FIRE

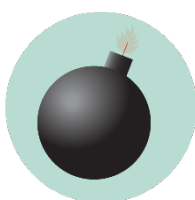

BOMB THREAT



**GAS
LEAK**



HAZMAT



**SEVERE
WEATHER**



HAZMAT

Evacuation

PROMPTS: Fire alarm, direction from the UNT Police or City of Denton Fire Department, an Eagle Alert, a visibly life-threatening situation

- Gather those around you and quickly leave through the nearest exit.
- Ask those around you with limited mobility if they need help and provide assistance, as able.
- If you take notice of someone unable to evacuate, note their location and tell first responders as soon as possible.
- Those with access and functional needs should immediately go to the nearest fire refuge area and call 911.
- Move at least 200 feet away from the building and stay off fire lanes.
- Comply with directions from first responders.

Shelter

PROMPTS: Eagle Alert, Outdoor Warning Sirens

- Go indoors immediately.
- Seek shelter on the lowest level of the building, away from windows and exterior walls.
- For tornadoes: Encourage others to shield their head and neck with arms and putting material such as furniture and blankets around themselves.
- If the event is HAZMAT related, completely turn off or seal off all external air sources including windows, doors, and air vents.
- Stay in shelter until an Eagle Alert is sent telling you it's safe to leave.

Medical Emergency

- Call 911 (or have someone call 911 for you).
- Send others to get an AED and to meet first responders at the door.
- Ask the individual if you have their permission to assist them.
 - If **YES**, provide first aid to the extent that you feel able.
 - If **NO**, move away from the individual and wait for first responders.
 - If **unconscious**, you have implied consent to provide assistance, as long as you are not negligent.
- Assist paramedics as needed when they arrive.
- Gather info and report the incident to Risk Management Services.



**MEDICAL
EMERGENCY**



**ACTIVE
THREAT**

Run. Hide. Fight.

PROMPTS: Eagle Alert; successive, loud shot noises; groups of individuals running and screaming

- **RUN** and escape the active threat if possible.
- **HIDE** from the active threat if escape is not possible.
- **FIGHT** the attacker as a last resort and commit to your actions.

CAMPUS EMERGENCY CONTACTS

<p>Any life-threatening emergency Active threat Acts or threats of violence Bomb threat Fire Hostage situation Life-threatening hazardous materials release Medical emergencies Natural gas leak Suicidal person Violent civil disturbance or demonstration Violent/threatening/hostile individual</p>	<p><i>Call or text 911 in life-threatening emergencies</i> 911</p>
<p>Any non-emergency concerns Civil disturbance or demonstration Disruptive person Elevator failure Suspicious person</p>	<p><i>UNT Police</i> 940-565-3000</p>
<p>Maintenance-related issues Power outage Water leak or flooding Property damage</p>	<p><i>UNT Facilities</i> 940-565-2700</p>
<p>Minor hazardous materials release</p>	<p><i>UNT Risk Management</i> 940-565-2109</p>

If you are unsure if a situation is or is not an emergency, always call 911.

DISCOVERY PARK EMERGENCY LOCATIONS AND SUPPLIES



Shelter Areas

- In the event of an incident requiring sheltering, all building occupants should take shelter in the underground tunnels if time permits, or in the interior hallways of wings E, F, or interior B classrooms. Personnel have been assigned to unlock the doorways to the underground tunnels.
- All individuals should avoid standing near windows, walls, and doors made of glass. If unable to safely move to the designated shelter area, seek shelter in a windowless interior room or hallway on the lowest floor of the building.

Evacuation Assembly Area

Evacuation Assembly Area

- In the event of an evacuation, all building occupants should immediately vacate the building and proceed to a designated Evacuation Assembly Area. The following locations are considered evacuation assembly areas:
 - Parking Lot 95 – Northwest of the building
 - Parking Lots 93 and 94 – Northeast of the building
 - Parking Lot 92 – South of the building
 - Parking Lot 91 – South of the building

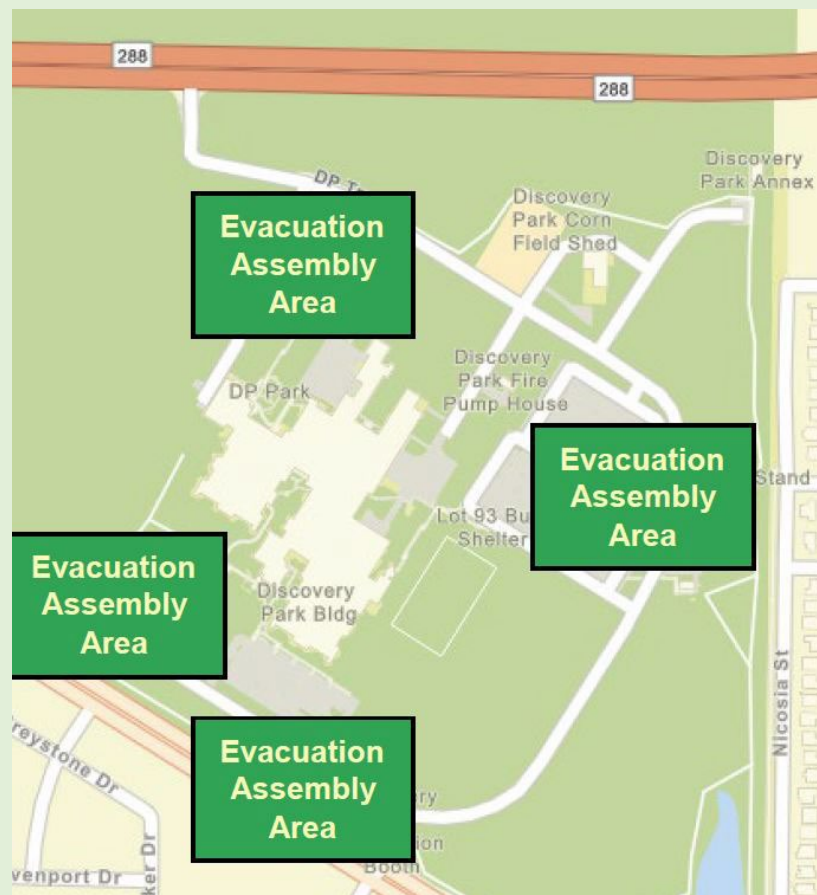



Medical Emergency Related Equipment

- **First Aid Kits:** Located in the UNT Police Room C104 and in other locations throughout the building.
- **Stop the Bleed Kits:** Co-located with AEDs in wall-boxes in the main Discovery Park building, and in the Machine Shop (F180) first aid kit.
- **AEDs:** First floor of Discovery Park, two on the second floor, and in the office area of the Discovery Park Annex.



Special Emergency Procedures for Discovery Park

- In the event of a Discovery Park full-campus evacuation, all individuals will be directed to leave the campus property through the campus entrance/exit, southeast of the main building.
- An entrance/exit to the northwest side of the building may be opened by public safety officers if egress is constrained.
 - The UNT Police and Discovery Park Public Safety Officers are the only individuals legally authorized to open this route of egress; a significant public safety threat must exist for this route to be made accessible.